

# Suspension system taraPLUS

Type: Adapted round tube Ø48

Material-No.: 144.38\*.\*\*\*

144.380.250 (L= 250 mm)

**144.380.500 (L= 500 mm)**

144.380.750 (L= 750 mm)

144.381.000 (L= 1000 mm)

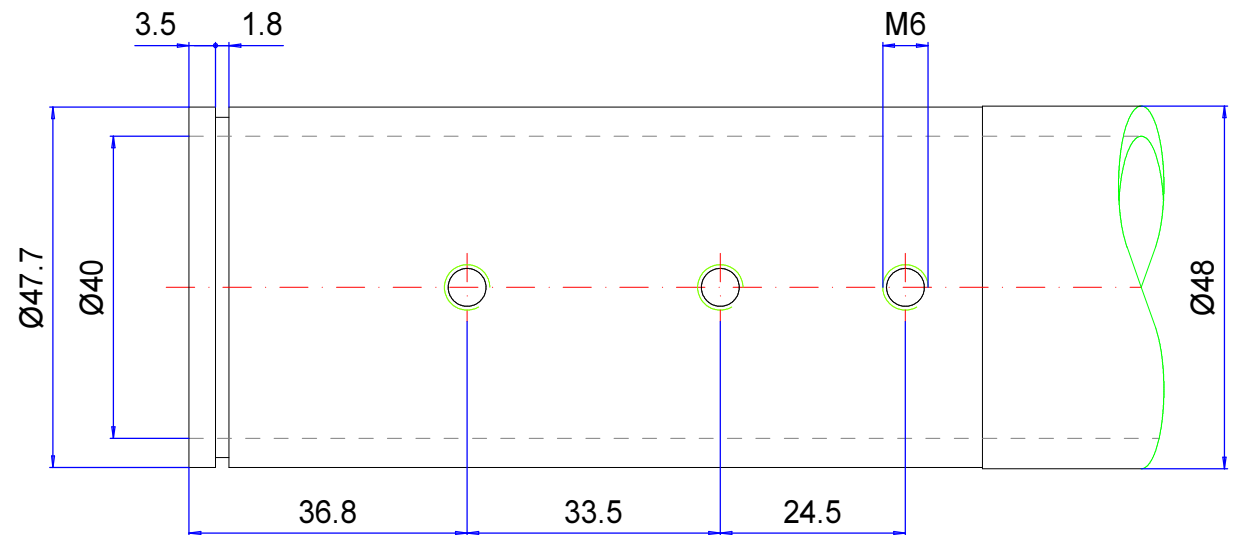

Material system elements	Steel, seamless, cold-drawn		Pivoting range	---
Gasket	---		Weight	3,600 kg/ m
Assembly screws	---		Coating	Powder coating RAL 9006, white aluminium
Ingress protection	IP54 EN 60529		Tolerance	EN 10305-4 (DIN 2391)